



# Rota-Bearing Rose & Doorknob Fitting Instructions

JOSEPH GILES

---

7 Imperial Way, Croydon, Surrey CR0 4RR  
+44 (0) 20 8680 2602 | [info@josephgiles.com](mailto:info@josephgiles.com) | [josephgiles.com](http://josephgiles.com)

The hole pattern will need to be created prior to fitting the doorknobs.

## Creating the Hole Pattern

The fitting jig will allow for the accurate creation of the following hole pattern. If you prefer to use a CNC router or create the pattern by hand, this is fine, however it's important to note that inaccurate hole patterns may impair the functionality of the doorknob.

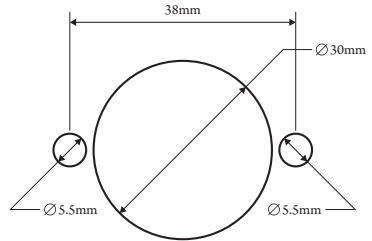

1. Start with your latch fitted into the door, and a hole drilled through to the 8mm square hole in the latch so that the square is fully visible from both the front and back faces of the door.

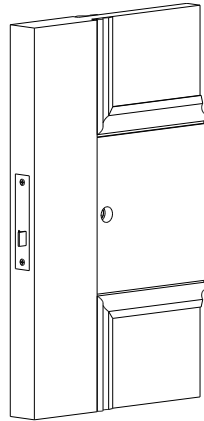

2. Insert the jig assembly into the square hole until the main body of the jig is touching the face of the door and is flat against it.

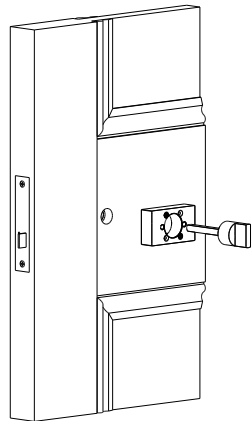

If you need any assistance with fitting please contact our team who are on hand to assist you.

JOSEPH GILES

7 Imperial Way, Croydon, Surrey CR0 4RR  
+44 (0) 20 8680 2602 | [info@josephgiles.com](mailto:info@josephgiles.com) | [josephgiles.com](http://josephgiles.com)

## Creating the Hole Pattern

3. Ensure the top or bottom of the jig is horizontal using a joiners square or spirit level. We recommend clamping the jig in place to avoid movement during the next stages.

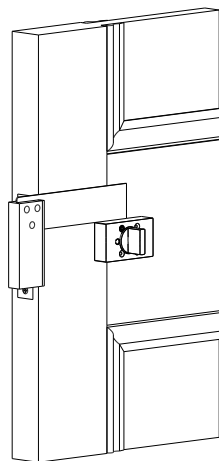

4. Screw and tighten the woodscrews included through either pair of the diagonally opposing holes in the jig, into the door.

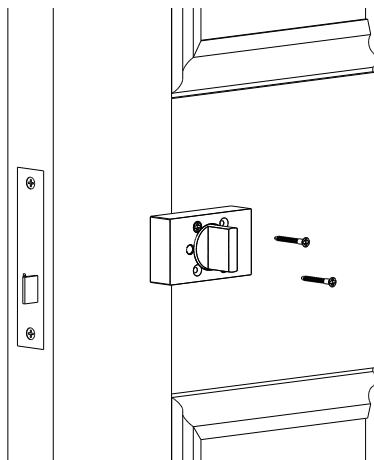

If you need any assistance with fitting please contact our team who are on hand to assist you.

JOSEPH GILES

7 Imperial Way, Croydon, Surrey CR0 4RR  
+44 (0) 20 8680 2602 | [info@josephgiles.com](mailto:info@josephgiles.com) | [josephgiles.com](http://josephgiles.com)

## Creating the Hole Pattern

5. Once the jig is screwed in place, remove the clamp (if used), and remove the centre part of the jig, leaving the square hole of the latch visible through the centre of the jig.

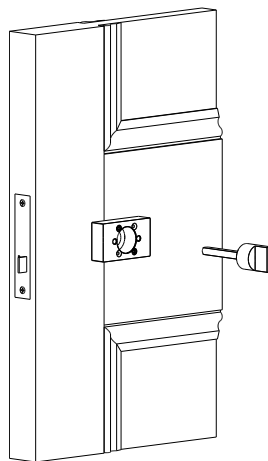

6. Remove the latch from the door.

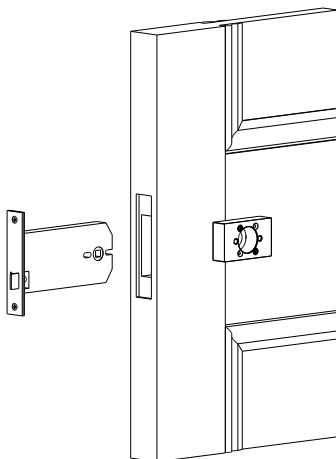

If you need any assistance with fitting please contact our team who are on hand to assist you.

JOSEPH GILES

7 Imperial Way, Croydon, Surrey CR0 4RR  
+44 (0) 20 8680 2602 | [info@josephgiles.com](mailto:info@josephgiles.com) | [josephgiles.com](http://josephgiles.com)

## Creating the Hole Pattern

7. Drill through the centre of the jig using a 30mm drill bit to a depth of at least 11mm but no further than the centre of the door.

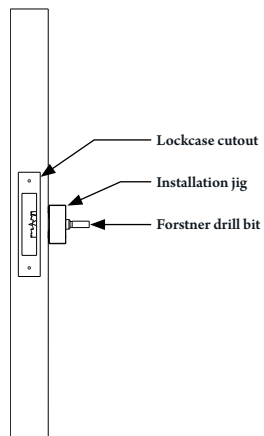
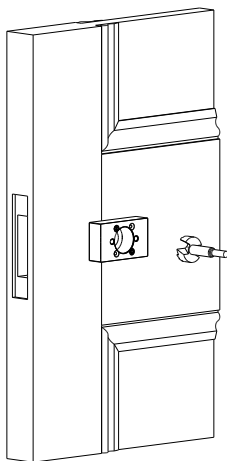

8. Drill through the horizontal holes of the jig using a 5.5mm drill bit to the centre of the door.

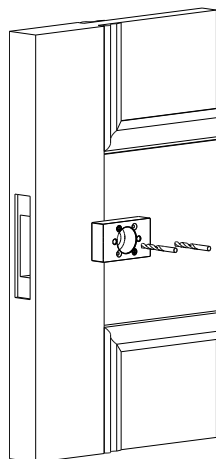

If you need any assistance with fitting please contact our team who are on hand to assist you.

JOSEPH GILES

7 Imperial Way, Croydon, Surrey CR0 4RR  
+44 (0) 20 8680 2602 | [info@josephgiles.com](mailto:info@josephgiles.com) | [josephgiles.com](http://josephgiles.com)

## Creating the Hole Pattern

9. Unscrew the woodscrews, removing the jig, and replace the latch into the door.

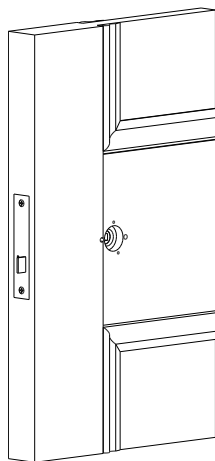

10. Repeat steps 2-8 on the opposite side of the door. This will complete the process for creating the hole pattern. You can now proceed with fitting the rota-bearing rose.

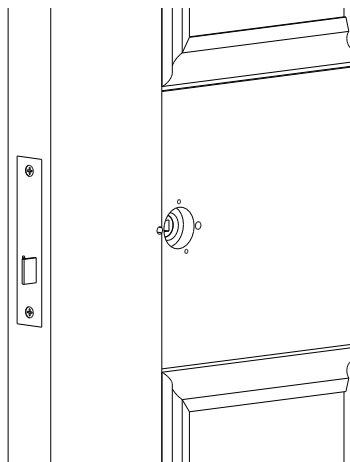

If you need any assistance with fitting please contact our team who are on hand to assist you.

JOSEPH GILES

7 Imperial Way, Croydon, Surrey CR0 4RR  
+44 (0) 20 8680 2602 | [info@josephgiles.com](mailto:info@josephgiles.com) | [josephgiles.com](http://josephgiles.com)

# Fitting the Rota-Bearing Rose

1. Insert both sides of the rota-bearing rose into the door.

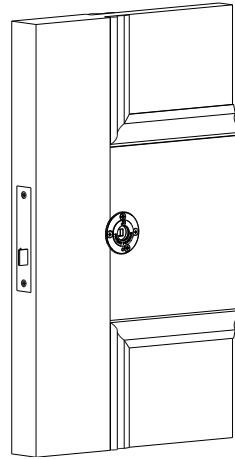

2. Insert the fixing bolts through the horizontal holes of the rota-bearing rose from one side, and the fixing nuts from the other side, then tighten together. The bolts may need to be shortened depending on the thickness of the door at one of the cut-off points along the length of the bolt.

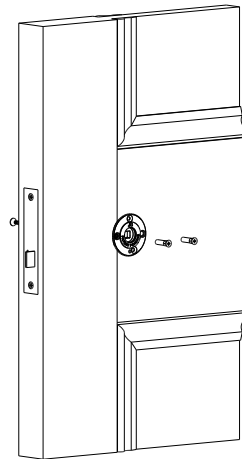

If you need any assistance with fitting please contact our team who are on hand to assist you.

JOSEPH GILES

7 Imperial Way, Croydon, Surrey CR0 4RR  
+44 (0) 20 8680 2602 | [info@josephgiles.com](mailto:info@josephgiles.com) | [josephgiles.com](http://josephgiles.com)

## Fitting the Rota-Bearing Rose

3. Screw the wood screws into the door through the remaining holes in the rota-bearing rose.

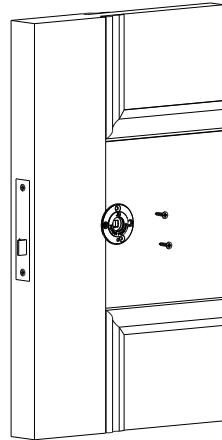

4. Push the 8mm spindle through the door (with the assistance of the handle if needed), ensuring the hole in the end of the spindle lines up with the location of the grub screw on the doorknob. This may require some force.

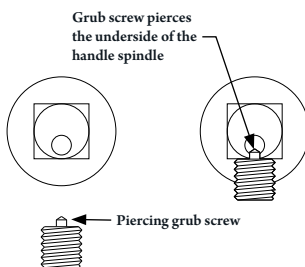

If you need any assistance with fitting please contact our team who are on hand to assist you.

JOSEPH GILES

7 Imperial Way, Croydon, Surrey CR0 4RR  
+44 (0) 20 8680 2602 | [info@josephgiles.com](mailto:info@josephgiles.com) | [josephgiles.com](http://josephgiles.com)



## Fitting the Rota-Bearing Rose

5. Ensuring the silicone O-rings are fully seated inside the groove around the rota-bearing rose, slowly push the outer rose over the rota-bearing rose until it's flush with the door. If the outer rose has an anti-rotation pin on the inside, you will need to ensure this lines up with the corresponding hole in the rota-bearing rose. If the fitment is too tight, wipe a very small amount of water around the inner rim of the outer rose.

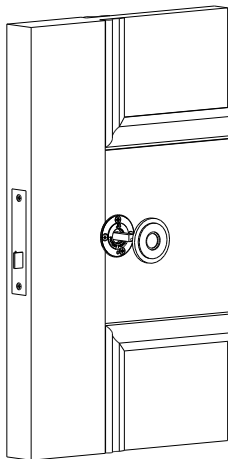

## Fitting a Doorknob

6. Ensuring the spindle projects an equal amount either side of the door, put the washer, then the knob over the rose on both sides of the door, and then tighten the grub screws. The grub screws will pierce the thin edge of the spindle creating a strong fitment.

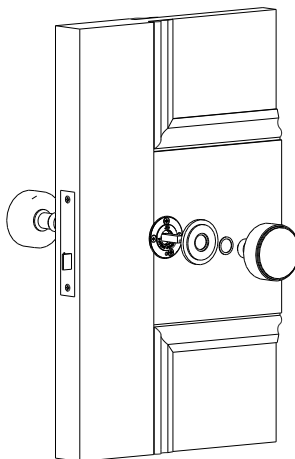
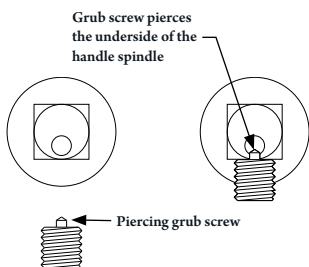

If you need any assistance with fitting please contact our team who are on hand to assist you.

JOSEPH GILES